

RECORDED IN THE PUBLIC RECORDS OF LEON CO. FLA.

MAR 31 6 34 AM '97

DAVE LANG
CLERK CIRCUIT COURT
LEON COUNTY, FLORIDA

This instrument prepared by:
Frank S. Shaw, III
Saith, Thompson & Shaw, P.A.
3520 Thomasville Rd., 4th Floor
Tallahassee, Florida 32308

FIRST AMENDMENT TO DECLARATION OF RESTRICTIVE COVENANTS
FOR MILLSTONE CREEK HOMEOWNERS ASSOCIATION, INC.,
TO PROVIDE FOR THE RECORDATION AND
IMPOSITION OF CONSERVATION AND DRAINAGE EASEMENTS
IN THE OFFICE OF THE CLERK OF THE COURT, IN
AND FOR LEON COUNTY, FLORIDA

WHEREAS, J. Marshall Conrad, Larry O. Strom and Shaw Securities, Inc., are the Declarants of that certain Declaration of Restrictive Covenants for Millstone Creek Homeowners Association, Inc., dated January 12, 1995, and recorded at Official Records Book 1789, Pages 681-714, Public Records of Leon County, Florida, and are record owners of more than two-thirds of the lots described in Exhibit A to said original Declaration of Restrictive Covenants; and

WHEREAS, it is the intent of the Declarants, as described above, to record in the Public Records of Leon County, Florida, evidence of conservation, drainage and vegetation management easements with respect to those certain lots described in Exhibit A to the original Declaration of Restrictive Covenants; and

WHEREAS, the Declarants are authorized by the terms of the original Declaration of Restrictive Covenants of record to amend said original Declaration of Restrictive Covenants so long as said Declarants own two-thirds or more of the lots as more particularly described in Exhibit A attached to the original Declaration of Restrictive Covenants;

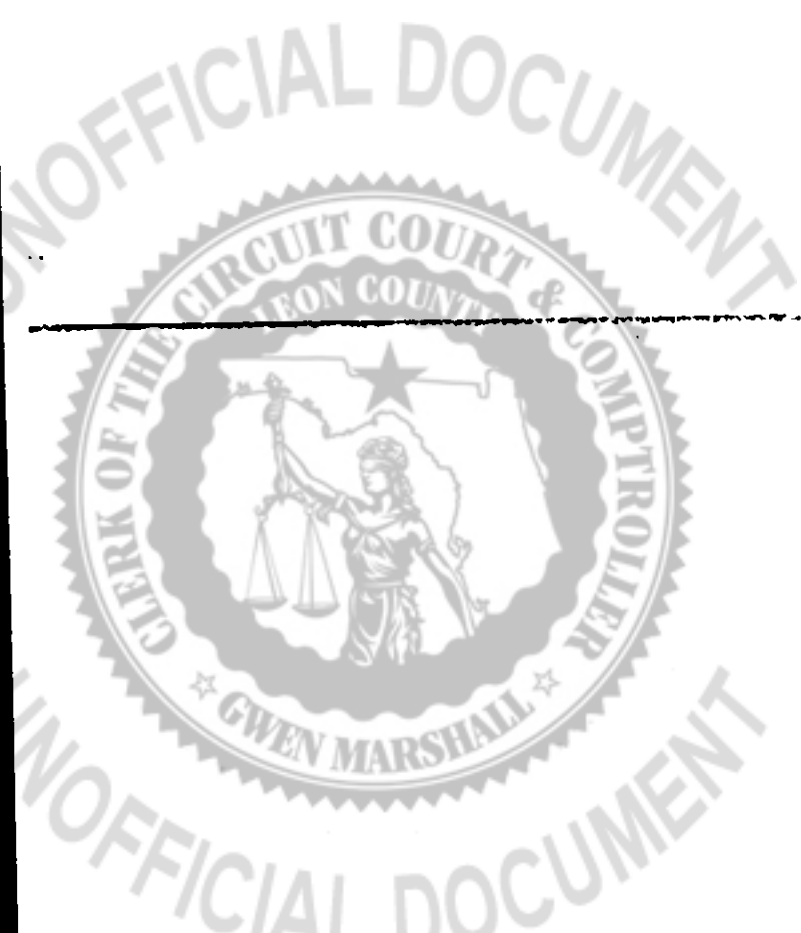

OR 1997PG0221

NOW, THEREFORE, by this Amendment the Declaration of Restrictive Covenants for Millstone Creek Homeowners Association, Inc., previously recorded at Official Records Book 1789, Pages 681-714, Public Records of Leon County, Florida, are hereby amended as follows:

1. Article X of the Declaration of Restrictive Covenants for Millstone Creek Homeowners Association, Inc., is amended to add in addition thereto; the following provision: A Conservation, Drainage and Vegetation Management Easement is hereby imposed on and upon that part of each lot lying within fifty (50) feet of the rear property line of each lot as more particularly described in Exhibit A of the Declaration of Restrictive Covenants recorded at Official Records Book 1789, Pages 701-710, Public Records of Leon County, Florida. In addition thereto, there is hereby imposed such Conservation, Drainage and Vegetation Management Easement over and across those portions of Lots 3, 4, 9, 10, 11, 12, 14, 21, 22, 23, 24, and 25 as described in Exhibit A to the original Declaration of Restrictive Covenants recorded at Official Records Book 1789, Pages 702-710, Public Records of Leon County, Florida, more particularly described as eight separate parcels on the twelve page Composite Exhibit A attached hereto. The property encumbered by this Conservation, Drainage and Vegetation Management Easement may not be improved unless and until a management plan has been reviewed and approved by the Architectural Control Committee of the Homeowners Association and the environmental permitting agency with primary jurisdiction.

IN WITNESS WHEREOF, the parties hereto have hereunto set their hands and seals this, the 14th day of March, 1997.

Signed, sealed and delivered in our presence as witnesses:

Betty R. Folsom

BETTY R. FOLSOM

Kristin H. Godfrey

KRISTIN H. GODFREY

Bret D. DeLesby

BRET D. DELESBY

Irene R. McKae

Irene R. McKae

J Marshall Conrad
J MARSHALL CONRAD

Larry O. Strom
LARRY O. STROM

Layna M. Kirkham

LAYNA M. KIRKHAM

Sue P. Mills

SUE P. MILLS

SHAW SECURITIES, INC.,
a Florida corporation

By: Prank S. Shaw, Jr.
PRANK S. SHAW, JR.
As its President

UNOFFICIAL DOCUMENT

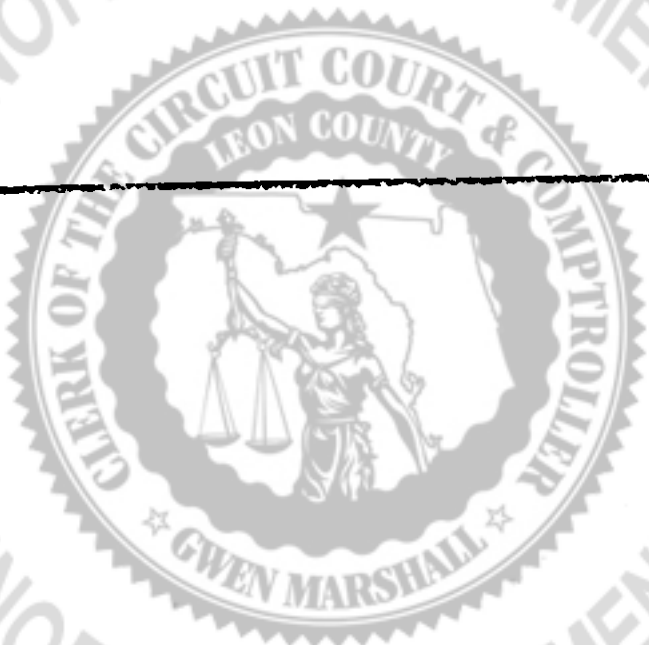

UNOFFICIAL DOCUMENT

OR 1997PG0223

STATE OF FLORIDA
COUNTY OF LEON

The foregoing instrument was acknowledged before me this 21st
day of March, 1997, by J. Marshall Conrad, who is
personally known to me, or who has produced
N/A as identification, and who did/did
not take an oath.



KRISTIN H. GODFREY
MY COMMISSION # CC291469 EXPIRES
July 7, 1997
BONDED THROUGH TROY FAIR INSURANCE, INC.

(Notary Seal)

Kristin H. Godfrey
Notary Public, State of Florida
at Large

KRISTIN H. GODFREY
Printed name of Notary

STATE OF FLORIDA
COUNTY OF LEON

The foregoing instrument was acknowledged before me this 24th
day of March, 1997, by Larry O. Strom, who is personally
known to me or who has produced
as
identification, and who did/did not take an oath.



CARRIE J. FEW
MY COMMISSION # CC407364 EXPIRES
September 14, 1998
BONDED THROUGH TROY FAIR INSURANCE, INC.

(Notary Seal)

Carrie J. Few
Notary Public, State of Florida
at Large

CARRIE J. FEW
Printed name of Notary

STATE OF FLORIDA
COUNTY OF LEON

The foregoing instrument was acknowledged before me this 14
day of March, 1997, by Frank S. Shaw, Jr., as President of
SHAW SECURITIES, INC., a Florida corporation, who is personally
known to me, or who has produced
as
identification, and who did/did not take an oath.



Lynn M. Kirham
MY COMMISSION # CC588230 EXPIRES
January 17, 1998
BONDED THROUGH TROY FAIR INSURANCE, INC.

(Notary Seal)

Lynn M. Kirham
Notary Public, State of Florida
at Large

Printed name of Notary

James "Thurman" Roddenberry DP 1007300224
Professional Land Surveyor

Post Office Box 418 • 114 Municipal Avenue • Sopchoppy, Florida 32358-0418 • (904) 962-2538

THIS IS NOT A BOUNDARY SURVEY

- NOTES:
1. SOURCE: Previous sketches by this firm (Job # 97-063, dated 2/20/97), and special instructions as per client.
 2. BEARING REFERENCE: North boundary of subject parcel being S 89°30'58" W as per (Job #97-063, dated 2/20/97) as prepared by this firm.
 3. NO FIELD WORK has been performed to verify the accuracy of the sketch shown hereon.

PLAT OF SPECIFIC PURPOSE TO SHOW
 COMPOSITE SKETCH OF EASEMENTS
 AT MILLSTONE CREEK FOR:
 MILLSTONE CREEK PARTNERS

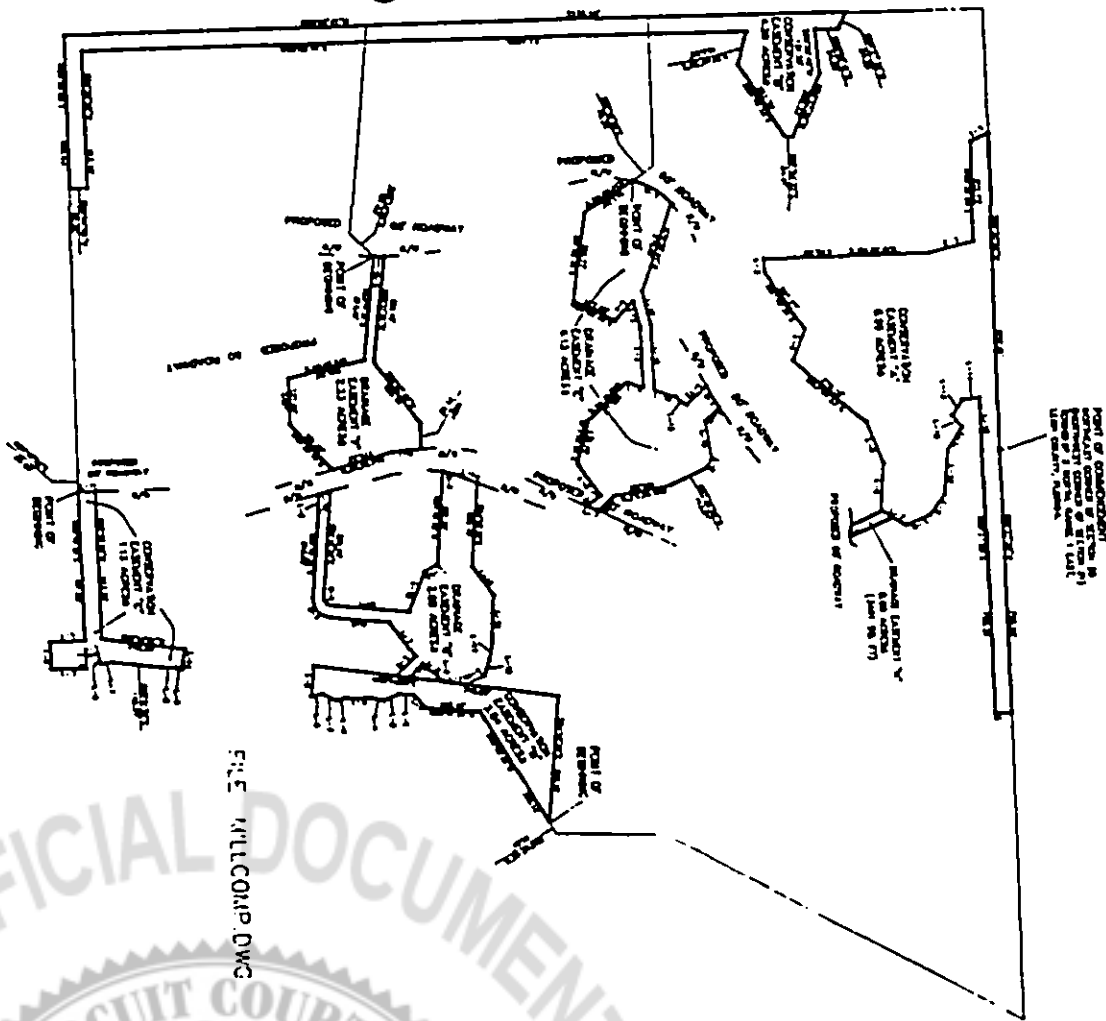

FILE: MILLCOPR.DWG

The undersigned surveyor has not been provided a current title opinion or abstract of matters affecting title or boundary to the subject property. It is possible there are deeds of records, unrecorded deeds, easements or other instruments which could affect the boundaries.

CERTIFICATE: I hereby certify that this is a true and correct representation of the property shown hereon and that this survey meets the minimum technical standards for land surveying (Chapter 61G17-6, Florida Administrative Code).

SEAL

James T. Roddenberry
 JAMES T. RODDENBERRY
 Surveyor & Mapper
 Florida Certificate No. 4261
 Date of Last Field Work
 none

Date 3/17/97
 Job No. 97-063
 N.B. none
 County Leon
 Sec. T- R-

FLOOD STATEMENT

ZONE: _____
 As per Federal Flood
 Insurance Rate Map
 Community Panel No. _____

Dated: _____
 PARCEL SKETCH
 Composite Exhibit "A"
 (1 of 12 Pages)

OR 1997PG 0225

James "Thurman" Roddenberry

Professional Land Surveyor

Post Office Box 418

Sopchoppy, Florida 32358-0418

(904) 962-2538

February 20, 1997

Certified to: Millstone Creek Partners

I hereby certify that this is a true and correct representation of the following described property and that this description meets the minimum technical standards for land surveying (Chapter 61G17-6, Florida Administrative Code).

Begin at the Northeast corner of Section 20 (Northwest corner of Section 21), Township 2 North, Range 1 East, Leon County, Florida. From said POINT OF BEGINNING run South 89 degrees 30 minutes 58 seconds West 958.61 feet, thence run South 24 degrees 33 minutes 01 seconds East 54.76 feet, thence run North 89 degrees 30 minutes 58 seconds East 303.73 feet, thence run South 13 degrees 16 minutes 35 seconds East 133.70 feet, thence run South 00 degrees 36 minutes 06 seconds East 470.45 feet, thence run North 84 degrees 57 minutes 35 seconds East 42.16 feet, thence run North 57 degrees 10 minutes 26 seconds East 207.27 feet, thence run South 69 degrees 07 minutes 22 seconds East 100.48 feet, thence run North 43 degrees 44 minutes 23 seconds East 275.15 feet, thence run North 70 degrees 43 minutes 05 seconds East 130.87 feet, thence run South 84 degrees 56 minutes 42 seconds East 140.13 feet, thence run North 35 degrees 22 minutes 20 seconds East 84.03 feet, thence run North 23 degrees 20 minutes 36 seconds West 72.58 feet, thence run North 53 degrees 02 minutes 38 seconds West 76.07 feet, thence run North 83 degrees 30 minutes 25 seconds West 132.89 feet, thence run North 56 degrees 58 minutes 06 seconds West 80.31 feet, thence run South 50 degrees 25 minutes 28 seconds West 44.10 feet, thence run North 55 degrees 28 minutes 19 seconds West 56.78 feet, thence run North 05 degrees 59 minutes 36 seconds West 51.12 feet, thence run North 89 degrees 30 minutes 58 seconds East 159.89 feet, thence run North 89 degrees 27 minutes 08 seconds East 790.24 feet, thence run North 50.00 feet, thence run South 89 degrees 27 minutes 08 West 790.69 feet to the POINT OF BEGINNING containing 8.96 acres, more or less.

NO FIELD work has been performed to verify the accuracy of the property described hereon.

The undersigned surveyor has not been provided a current title opinion or abstract of matters affecting title or boundary to the subject property. It is possible there are deeds of records, unrecorded deeds, easements or other instruments which could affect the boundaries.

CONSERVATION EASEMENT "A"
Composite Exhibit "A"
(2 of 12 Pages)

JAMES T. RODDENBERRY
Surveyor and Mapper

James "Thurman" Roddenberry

Professional Land Surveyor

Post Office Box 418

Sopchoppy, Florida 32358-0418

(904) 962-2538

February 20, 1997

Certified to: Millstone Creek Partners

I hereby certify that this is a true and correct representation of the following described property and that this description meets the minimum technical standards for land surveying (Chapter 61G17-6, Florida Administrative Code).

Commence at the Northeast corner of Section 20 (Northwest corner of Section 21), Township 2 North, Range 1 East, Leon County, Florida and run South 89 degrees 30 minutes 58 seconds West 1334.86 feet, thence run South 00 degrees 02 minutes 41 seconds West 388.43 feet to the POINT OF BEGINNING. From said POINT OF BEGINNING continue South 00 degrees 02 minutes 41 seconds West 2235.16 feet, thence run North 89 degrees 50 minutes 55 seconds East 462.63 feet, thence run North 00 degrees 09 minutes 06 seconds West 50.00 feet, thence run South 89 degrees 50 minutes 55 seconds West 412.46 feet, thence run North 00 degrees 02 minutes 41 seconds East 1897.73 feet, thence run South 75 degrees 40 minutes 38 seconds East 103.02 feet, thence run North 59 degrees 46 minutes 53 seconds East 252.39 feet, thence run North 05 degrees 54 minutes 32 seconds East 24.61 feet, thence run North 66 degrees 27 minutes 38 seconds West 206.33 feet, thence run South 86 degrees 33 minutes 45 seconds West 131.36 feet, thence run North 00 degrees 02 minutes 41 seconds East 64.98 feet, thence run North 66 degrees 27 minutes 38 seconds West 54.52 feet to the POINT OF BEGINNING containing 4.20 acres, more or less.

NO FIELD work has been performed to verify the accuracy of the property described hereon.

The undersigned surveyor has not been provided a current title opinion or abstract of matters affecting title or boundary to the subject property. It is possible there are deeds of records, unrecorded deeds, easements or other instruments which could affect the boundaries.

CONSERVATION EASEMENT "B"
Composite Exhibit "A"
(3 of 12 Pages)



JAMES T. RODDENBERRY
Surveyor and Mapper
Florida Certificate No: 4261

97-063-B



UNOFFICIAL DOCUMENT

OR 1997PG0227

James "Thurman" Roddenberry

Professional Land Surveyor

Post Office Box 418

Sopchoppy, Florida 32358-0418

(904) 962-2538

February 20, 1997

Certified to: Millstone Creek Partners

I hereby certify that this is a true and correct representation of the following described property and that this description meets the minimum technical standards for land surveying (Chapter 61G17-6, Florida Administrative Code).

Commence at the Northeast corner of Section 20 (Northwest corner of Section 21), Township 2 North, Range 1 East, Leon County, Florida, and run South 89 degrees 30 minutes 58 seconds West 1334.86 feet, thence run South 00 degrees 02 minutes 41 seconds West 2623.58 feet, thence run North 89 degrees 50 minutes 55 seconds East 1322.98 feet, thence run North 89 degrees 49 minutes 52 seconds East 60.00 feet to the Easterly right-of-way of a proposed 60.00 foot wide roadway for the POINT OF BEGINNING. From said POINT OF BEGINNING and leaving said right-of-way run North 89 degrees 49 minutes 52 seconds East 451.90 feet, thence run South 00 degrees 12 minutes 28 seconds East 100.02 feet, thence run North 89 degrees 47 minutes 04 seconds East 81.68 feet, thence run North 01 degrees 31 minutes 36 seconds East 101.52 feet, thence run South 89 degrees 34 minutes 33 seconds West 38.73 feet, thence run North 11 degrees 26 minutes 51 seconds West 36.33 feet, thence run North 74 degrees 38 minutes 15 seconds East 35.15 feet, thence run North 10 degrees 22 minutes 36 seconds West 33.51 feet, thence run North 08 degrees 41 minutes 57 seconds East 145.37 feet, thence run North 01 degrees 19 minutes 09 seconds East 38.07 feet, thence run North 21 degrees 40 minutes 47 seconds East 17.96 feet, thence run North 79 degrees 36 minutes 47 seconds West 63.02 feet, thence run South 09 degrees 14 minutes 01 seconds West 242.34 feet, thence run South 89 degrees 49 minutes 50 seconds West 447.33 feet to the Easterly right-of-way of a proposed 60.00 foot wide roadway, thence run South 00 degrees 10 minutes 10 seconds East along said right-of-way 50.00 feet to the POINT OF BEGINNING containing 1.12 acres, more or less.

NO FIELD work has been performed to verify the accuracy of the property described hereon.

The undersigned surveyor has not been provided a current title opinion or abstract of matters affecting title or boundary to the subject property. It is possible there are deeds of records, unrecorded deeds, easements or other instruments which could affect the boundaries.

JAMES G. RODDENBERRY
Surveyor and Mapper
Florida Certificate No: 4261

CONSERVATION EASEMENT "C"
Composite Exhibit "A"
(4 of 12 Pages)

97-063-C

James "Thurman" Roddenberry

Professional Land Surveyor

Post Office Box 418

Sopchoppy, Florida 32358-0418

(904) 962-2538

February 20, 1997

Certified to: Millstone Creek Partners

I hereby certify that this is a true and correct representation of the following described property and that this description meets the minimum technical standards for land surveying (Chapter 61G17-6, Florida Administrative Code).

Commence at the Northeast corner of Section 20 (Northwest corner of Section 21), Township 2 North, Range 1 East, Leon County, Florida and run North 89 degrees 27 minutes 08 seconds East 1721.79 feet, thence run South 30 degrees 24 minutes 16 seconds West 1165.15 feet, thence run South 02 degrees 16 minutes 45 seconds West 310.54 feet, thence run South 60 degrees 48 minutes 45 seconds West 38.61 feet to the POINT OF BEGINNING. From said POINT OF BEGINNING continue South 60 degrees 48 minutes 45 seconds West 392.14 feet, thence run South 05 degrees 41 minutes 24 seconds West 155.45 feet, thence run South 51 degrees 36 minutes 36 seconds West 50.15 feet, thence run South 06 degrees 27 minutes 19 seconds West 43.71 feet, thence run South 22 degrees 53 minutes 17 seconds East 47.81 feet, thence run South 17 degrees 04 minutes 07 seconds West 29.27 feet, thence run South 02 degrees 29 minutes 38 seconds West 83.58 feet, thence run South 17 degrees 23 minutes 21 seconds East 25.60 feet, thence run South 27 degrees 22 minutes 00 seconds West 48.55 feet, thence run South 16 degrees 47 minutes 30 seconds East 30.78 feet, thence run North 84 degrees 18 minutes 36 seconds West 94.41 feet, thence run North 09 degrees 14 minutes 01 seconds East 710.88 feet, thence run South 84 degrees 18 minutes 36 seconds East 383.15 feet to the POINT OF BEGINNING containing 2.04 acres, more or less.

NO FIELD work has been performed to verify the accuracy of the property described hereon.

The undersigned surveyor has not been provided a current title opinion or abstract of matters affecting title or boundary to the subject property. It is possible there are deeds of records, unrecorded deeds, easements or other instruments which could affect the boundaries.

CONSERVATION EASEMENT "D"
Composite Exhibit "A"
(5 of 12 Pages)

JAMES T. RODDENBERRY
Surveyor and Mapper
Florida Certificate No.: 4261

97-063-D

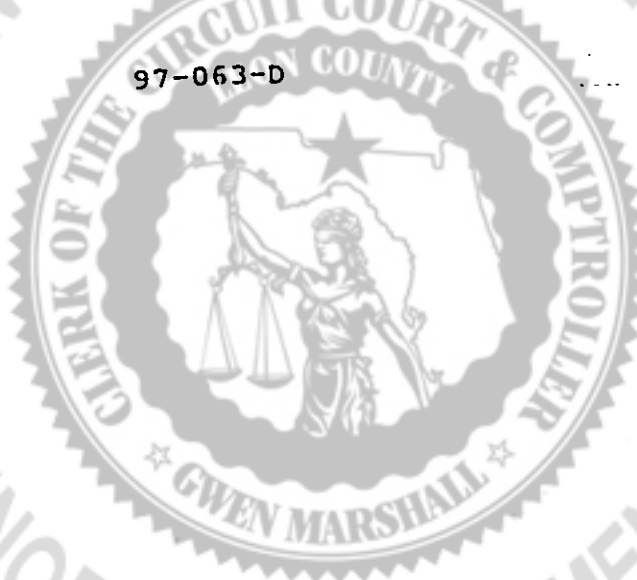

OR 1997PG0229

James "Thurman" Roddenberry

Professional Land Surveyor

Post Office Box 418

Sopchoppy, Florida 32358-0418

(904) 962-2538

February 20, 1997

Certified to: Millstone Creek Partners

I hereby certify that this is a true and correct representation of the following described property and that this description meets the minimum technical standards for land surveying (Chapter 61G17-6, Florida Administrative Code).

Commence at the Northeast corner of Section 20 (Northwest corner of Section 21), Township 2 North, Range 1 East, Leon County, Florida and run South 89 degrees 30 minutes 58 seconds West 1334.86 feet, thence run South 00 degrees 02 minutes 41 seconds West 952.38 feet, thence run South 89 degrees 57 minutes 19 seconds East 447.64 feet, thence run South 37 degrees 10 minutes 20 seconds East 70.34 feet to the Southeasterly right-of-way a proposed 60.00 foot wide roadway for the POINT OF BEGINNING. From said POINT OF BEGINNING and leaving said right-of-way run South 34 degrees 50 minutes 03 seconds East 163.55 feet, thence run South 81 degrees 52 minutes 32 seconds East 269.77 feet, thence run North 29 degrees 45 minutes 46 seconds East 127.98 feet, thence run North 46 degrees 23 minutes 44 seconds West 79.48 feet, thence run North 78 degrees 21 minutes 04 seconds East 81.31 feet, thence run North 88 degrees 59 minutes 50 seconds East 181.09 feet, thence run South 18 degrees 37 minutes 42 seconds West 46.66 feet, thence run South 45 degrees 01 minutes 14 seconds East 155.13 feet, thence run South 75 degrees 02 minutes 54 seconds East 136.79 feet, thence run North 59 degrees 19 minutes 06 seconds East 108.87 feet, thence run South 42 degrees 12 minutes 45 seconds East 46.32 feet to the Westerly right-of-way of a proposed 60.00 foot wide roadway, thence run North 24 degrees 40 minutes 41 seconds East along said right-of-way 32.62 feet, thence leaving said right-of-way run North 42 degrees 17 minutes 07 seconds West 60.78 feet, thence run 09 degrees 45 minutes 53 seconds West 164.98 feet, thence run North 27 degrees 36 minutes 52 seconds West 113.07 feet, thence run North 60 degrees 32 minutes 30 seconds West 30.10 feet, thence run South 81 degrees 28 minutes 24 seconds West 111.13 feet, thence run North 42 degrees 12 minutes 45 seconds West 60.82 feet to the Southeasterly right-of-way of a proposed 60.00 foot wide roadway, said point lying on a curve concave to the Northwesterly, thence run Southwesterly along said right-of-way and along the arc of said curve with a radius of 547.67 feet, through a central angle of 08 degrees 01 minutes 05 seconds, for an arc distance of 76.64 feet, chord being South 60 degrees 25 minutes 39 seconds West 76.58 feet, thence leaving said right-of-way run South 44 degrees 40 minutes 33 seconds East 80.56 feet, thence run South 45 degrees 27 minutes 05 seconds West 36.65 feet, thence run South

DRAINAGE EASEMENT "E"
Composite Exhibit "A"
(6 of 12 Pages)

18 degrees 37 minutes 42 seconds West 65.28 feet, thence run South 88 degrees 59 minutes 50 seconds West 194.59 feet, thence run South 78 degrees 21 minutes 04 seconds West 107.36 feet, thence run North 70 degrees 50 minutes 44 seconds West 278.02 feet to the Southeasterly right-of-way of a proposed 60.00 foot wide roadway, said point lying on a curve concave to the Southeasterly, thence run Southwesterly along said right-of-way and along the arc of said curve with a radius of 220.00 feet, through a central angle of 35 degrees 06 minutes 13 seconds, for an arc distance of 134.79 feet, chord being South 34 degrees 25 minutes 16 seconds West 132.69 feet to the POINT OF BEGINNING containing 4.13 acres, more or less.

NO FIELD work has been performed to verify the accuracy of the property described hereon.

The undersigned surveyor has not been provided a current title opinion or abstract of matters affecting title or boundary to the subject property. It is possible there are deeds of records, unrecorded deeds, easements or other instruments which could affect the boundaries.



JAMES T. RODDENBERRY
Surveyor and Mapper
Florida Certificate No: 4261

DRAINAGE EASEMENT "E" (continued)
Composite Exhibit "A"
(7 of 12 Pages)

97-063-E



OR 1997PG0231

James "Thurman" Roddenberry

Professional Land Surveyor

Post Office Box 418

Sopchoppy, Florida 32358-0418

(904) 962-2533

February 20, 1997

Certified to: Millstone Creek Partners

I hereby certify that this is a true and correct representation of the following described property and that this description meets the minimum technical standards for land surveying (Chapter 61G17-6, Florida Administrative Code).

Commence at the Northeast corner of Section 20 (Northwest corner of Section 21), Township 2 North, Range 1 East, Leon County, Florida and run South 89 degrees 30 minutes 58 seconds West 1334.86 feet, thence run South 00 degrees 02 minutes 41 seconds West 1759.03 feet, thence run South 84 degrees 05 minutes 28 seconds East 628.32 feet, thence run North 46 degrees 18 minutes 58 seconds East 101.53 feet to the Easterly right-of-way of a proposed 60.00 foot wide roadway for the POINT OF BEGINNING. From said POINT OF BEGINNING and leaving said right-of-way run South 83 degrees 11 minutes 31 seconds East 314.41 feet, thence run South 12 degrees 39 minutes 04 seconds East 225.98 feet, thence run East 137.86 feet, thence run North 49 degrees 38 minutes 40 seconds East 181.83 feet to the Westerly right-of-way of a proposed 60.00 foot wide roadway, thence run North 14 degrees 34 minutes 28 seconds West along said right-of-way 173.33 feet to a point of curve to the right, thence run Northerly along said right-of-way and along the arc of said curve with a radius of 363.00 feet, through a central angle of 14 degrees 20 minutes 30 seconds, for an arc distance of 90.86 feet, chord being North 05 degrees 28 minutes 33 seconds West 90.63 feet, thence leaving said right-of-way run West 77.18 feet, thence run South 56 degrees 07 minutes 40 seconds West 226.14 feet, thence run North 83 degrees 11 minutes 31 seconds West 321.12 feet to the Easterly right-of-way of a proposed 60.00 foot wide roadway, said point lying on a curve concave to the Westerly, thence run Southerly along said right-of-way and along the arc of said curve with a radius of 530.00 feet, through a central angle of 03 degrees 14 minutes 52 seconds, for an arc distance of 30.04 feet, chord being South 03 degrees 54 minutes 05 seconds West 30.04 feet to the POINT OF BEGINNING containing 2.23 acres, more or less.

NO FIELD work has been performed to verify the accuracy of the property described hereon.

DRAINAGE EASEMENT "F"
Composite Exhibit "A"
(8 of 12 Pages)

The undersigned surveyor has not been provided a current title opinion or abstract of matters affecting title or boundary to the subject property. It is possible there are deeds of records, ~~unrecorded deeds~~, easements or other instruments which could affect the boundaries.



JAMES T. RODDENBERRY
Surveyor and Mapper
Florida Certificate No: 4261

97-063-F

DRAINAGE EASEMENT "F" (continued)
Composite Exhibit "A"
(9 of 12 Pages)

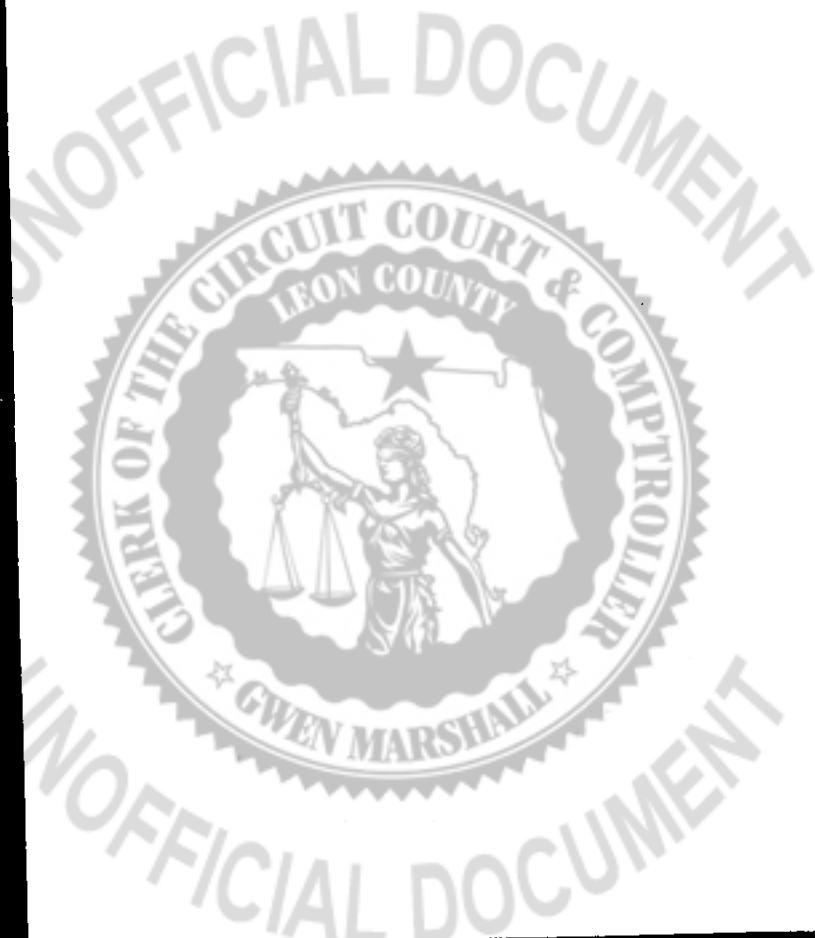

James "Thurman" Roddenberry

Professional Land Surveyor

Post Office Box 418

Sopchoppy, Florida 32358-0418

(904) 962-2538

February 20, 1997

Certified to: Millstone Creek Partners

I hereby certify that this is a true and correct representation of the following described property and that this description meets the minimum technical standards for land surveying (Chapter 61G17-6, Florida Administrative Code).

Commence at the Northeast corner of Section 20 (Northwest corner of Section 21), Township 2 North, Range 1 East, Leon County, Florida and run North 89 degrees 27 minutes 08 seconds East 1721.79 feet, thence run South 30 degrees 24 minutes 16 seconds West 1165.15 feet, thence run South 02 degrees 16 minutes 45 seconds West 310.54 feet, thence run South 60 degrees 48 minutes 45 seconds West 38.61 feet, thence run North 84 degrees 18 minutes 36 seconds West 383.15 feet, thence run South 09 degrees 14 minutes 01 seconds West 271.45 feet to the POINT OF BEGINNING. From said POINT OF BEGINNING continue South 09 degrees 14 minutes 01 seconds West 60.88 feet, thence run South 39 degrees 53 minutes 19 seconds West 26.54 feet, thence run South 44 degrees 42 minutes 00 seconds West 55.02 feet, thence run South 45 degrees 18 minutes 00 seconds East 56.02 feet, thence run South 09 degrees 16 minutes 44 seconds West 36.81 feet, thence run North 45 degrees 18 minutes 00 seconds West 80.30 feet, thence run South 55 degrees 47 minutes 03 seconds West 128.37 feet, thence run South 06 degrees 54 minutes 31 seconds West 170.51 feet to a point of curve to the right, thence run Southwesterly along said curve with a radius of 55.00 feet, through a central angle of 88 degrees 46 minutes 53 seconds, for an arc distance of 85.22 feet, chord being South 51 degrees 17 minutes 58 seconds West 76.95 feet, thence run North 84 degrees 18 minutes 36 seconds West 263.95 feet, thence run North 88 degrees 23 minutes 41 seconds West 49.50 feet to the Easterly-right of way of a proposed 60 foot wide roadway, thence run North 14 degrees 34 minutes 28 seconds West along said right of way 35.74 feet, thence leaving said right of way run South 84 degrees 18 minutes 36 seconds East 320.70 feet to a point of curve to the left, thence run Northeasterly along the arc of said curve with a radius of 25.00 feet, through a central angle of 88 degrees 46 minutes 53 seconds for an arc distance of 38.74 feet, chord being North 51 degrees 17 minutes 58 seconds East 34.98 feet, thence run North 06 degrees 54 minutes 31 seconds East 224.49 feet, thence run North 67 degrees 28 minutes 26 seconds West 130.51 feet, thence run North 30 degrees 46 minutes 47 seconds West 41.75 feet, thence run North 84 degrees 18 minutes 36 seconds West 281.28 feet to the Easterly right of way of a proposed 60 foot wide roadway, said point lying on a curve concave to the southeasterly, thence run Northeasterly along said right-of-way and along the arc

DRAINAGE EASEMENT "G"
Composite Exhibit "A"
(10 of 12 Pages)

OR 1997 PG 0233

of said curve with a radius of 303.00 feet, through a central angle of 09 degrees 05 minutes 50, for an arc distance 48.11 feet, chord being North 18 degrees 01 minutes 11 seconds East 48.06 feet, thence run North 24 degrees 40 minutes 41 seconds East along said right-of-way 56.10 feet, thence leaving said right-of-way run South 84 degrees 18 minutes 36 seconds East 252.76 feet, thence run North 56 degrees 55 minutes 38 seconds East 106.35 feet, thence run South 86 degrees 27 minutes 32 seconds East 144.23 feet, thence run South 78 degrees 20 minutes 37 seconds East 50.50 feet, thence run South 71 degrees 26 minutes 06 seconds East 50.72 feet, thence run South 24 degrees 04 minutes 09 seconds East 60.07 feet to the POINT OF BEGINNING containing 2.80 acres, more or less.

NO FIELD WORK has been performed to verify the accuracy of the property described hereon.

The undersigned surveyor has not been provided a current title opinion or abstract of matters affecting title or boundary to the subject property. It is possible there are deeds of records, unrecorded deeds, easements or other instruments which could affect the boundaries.



JAMES T. RODDENBERRY
Surveyor and Mapper
Florida Certificate No: 4261

DRAINAGE EASEMENT "G" (continued)
Composite Exhibit "A"
(11 of 12 Pages)

97-063-G



OR 1997PG0235

James "Thurman" Roddenberry

Professional Land Surveyor

Post Office Box 418

Sopchoppy, Florida 32358-0418

(904) 962-2538

February 20, 1997

Certified to: Millstone Creek Partners

I hereby certify that this is a true and correct representation of the following described property and that this description meets the minimum technical standards for land surveying (Chapter 61G17-6, Florida Administrative Code).

Commence at the Northeast corner of Section 20 (Northwest corner of Section 21), Township 2 North, Range 1 East, Leon County Florida and run North 89 degrees 27 minutes 08 seconds East 25.22 feet, thence run South 25 degrees 17 minutes 44 seconds East 179.84 feet, thence run South 83 degrees 30 minutes 25 seconds East 24.13 feet, thence run South 53 degrees 02 minutes 38 seconds East 76.07 feet, thence run South 23 degrees 20 minutes 36 seconds East 72.58 feet, thence run South 35 degrees 22 minutes 20 seconds West 44.11 feet to the POINT OF BEGINNING. From said POINT OF BEGINNING run South 25 degrees 17 minutes 44 seconds East 133.96 feet to the Northerly right of way of a proposed 60 foot roadway said point lying on a curve concave to the Northerly, thence run Westerly along said right of way and along the arc of said curve with a radius of 30.00 feet, through a central angle of 11 degrees 58 minutes 23 seconds, for an arc distance of 6.27 feet, chord being North 82 degrees 20 minutes 54 seconds West 6.26 feet to a point of reverse curve to the left, thence run Westerly along said right of way and along said reverse curve with a radius of 228.00 feet, through a central angle of 07 degrees 36 minutes 36 seconds for an arc distance of 30.28 feet, chord being North 80 degrees 10 minutes 01 seconds West 30.26 feet, thence leaving said right of way run North 25 degrees 17 minutes 44 seconds West 90.77 feet, thence run North 84 degrees 56 minutes 42 seconds West 5.57 feet, thence run North 35 degrees 22 minutes 20 seconds East 39.92 feet to the POINT OF BEGINNING containing 0.08 acres, more or less. (3461 Square feet)

NO FIELD work has been performed to verify the accuracy of the property described hereon.

The undersigned surveyor has not been provided a current title opinion or abstract of matters affecting title or boundary to the subject property. It is possible there are deeds of records, unrecorded deeds, easements or other instruments which could affect the boundaries.

DRAINAGE EASEMENT "H"
Composite Exhibit "A"
(12 of 12 Pages)

JAMES T. RODDENBERRY
Surveyor and Mapper